

**Other enabling procedures**

On T range cranes with FX500 electronic lifting moment limiting device and no radio remote control, in order to enable the outriggers it is necessary to follow these procedures:

- (from main panel) select the icon  and press the "OK/ENTER" button;
- (from basic user panel) press simultaneously the buttons for activation of acoustic alarm and temporised exclusion device of the lifting moment limiting device (LEDs signalling XP activation and load percentage start flashing).

**6.3.4 - Controlling the outriggers**

As general procedure, extend all the outrigger supports, place the tiltable outrigger rams (if fitted) into working position (refer to the following paragraphs) and then extend all the outrigger rams till they are solidly placed on the ground.

Outriggers are numbered from 1 to 4, as shown for example in figure 6.6.

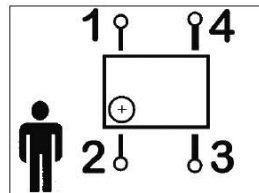

Fig. 6.6

On the outrigger controls (selection and control) letter **E** indicates hydraulically extendable outrigger supports, letter **S** hydraulic outrigger rams and letter **R** the pivoting of the hydraulically tiltable outrigger rams.

In order to operate the outrigger, in case of 5-function-distributor select the element you want to activate and at the same time operate the control lever.

In case of 2-function-distributor with deviator, select the element you want to activate and afterwards operate the control lever.

In case of 2-function-distributor without deviator, it is sufficient to operate the control lever.

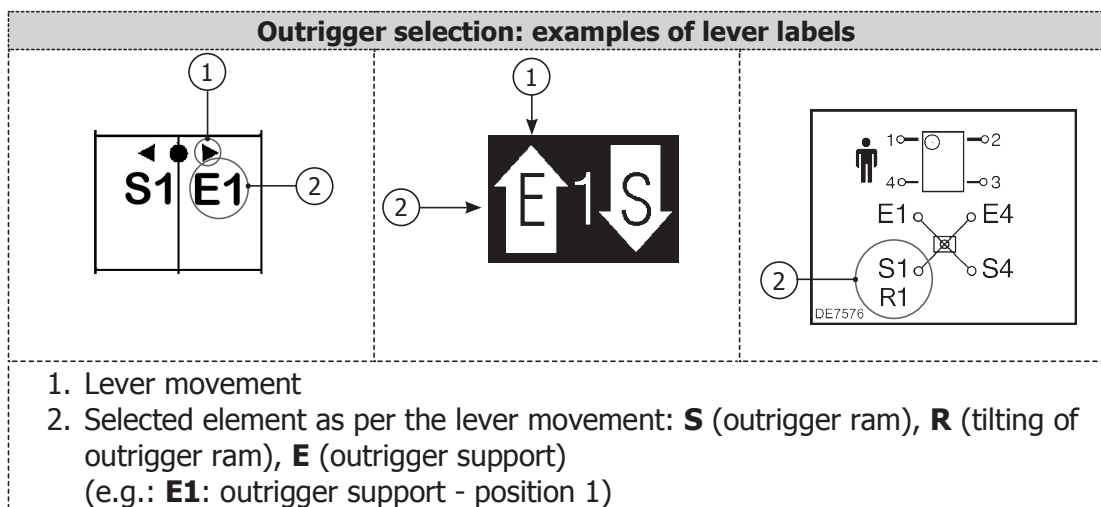

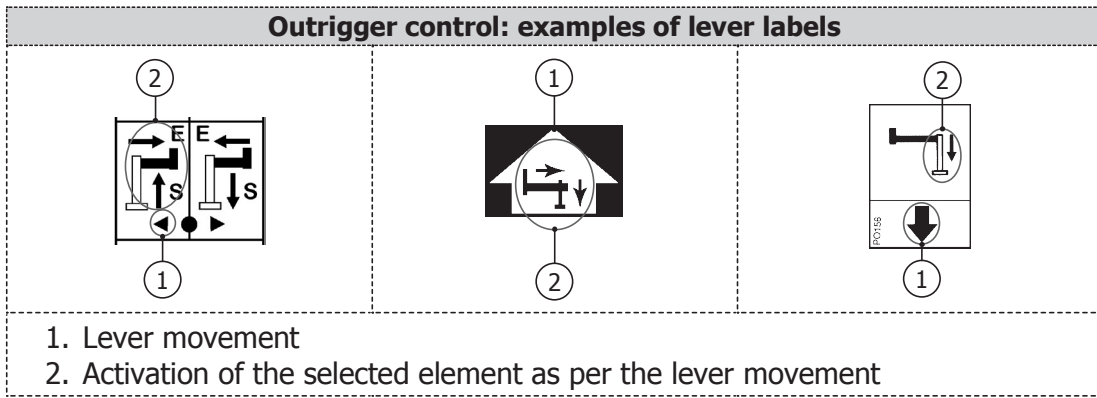

Refer to the relevant paragraphs of chapter 5 "Control systems" for the technical specifications related to the different control systems.



The complete extension of outrigger supports is visually indicated by yellow triangles near the edge of the beam (fig. 6.7) and the edge of supports (if they are multi-extendable - fig. 6.8).

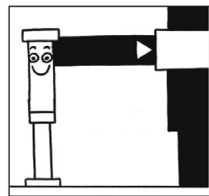

Fig. 6.7

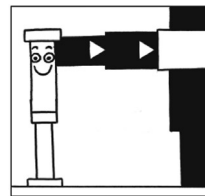
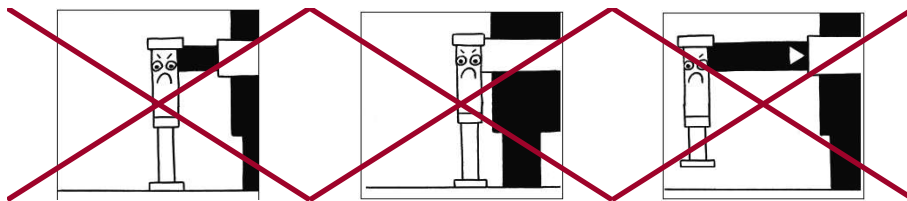
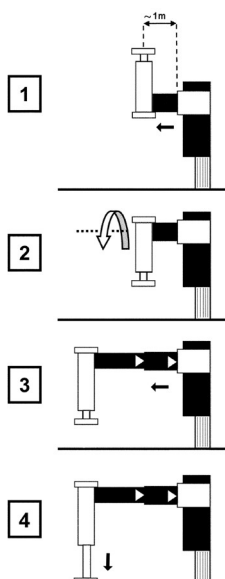

Fig. 6.8



If the crane is fitted with tiltable outrigger rams, follow this operating procedure for every outrigger.



1. Extend the outrigger support for about 1 meter
2. Place the tiltable outrigger ram into working position (vertically towards the ground)
3. Extend the outrigger support completely
4. Extend the outrigger ram till it is solidly placed on the ground

**Examples of outrigger operation**

- Extension of outrigger support - position 2 (**E2**)

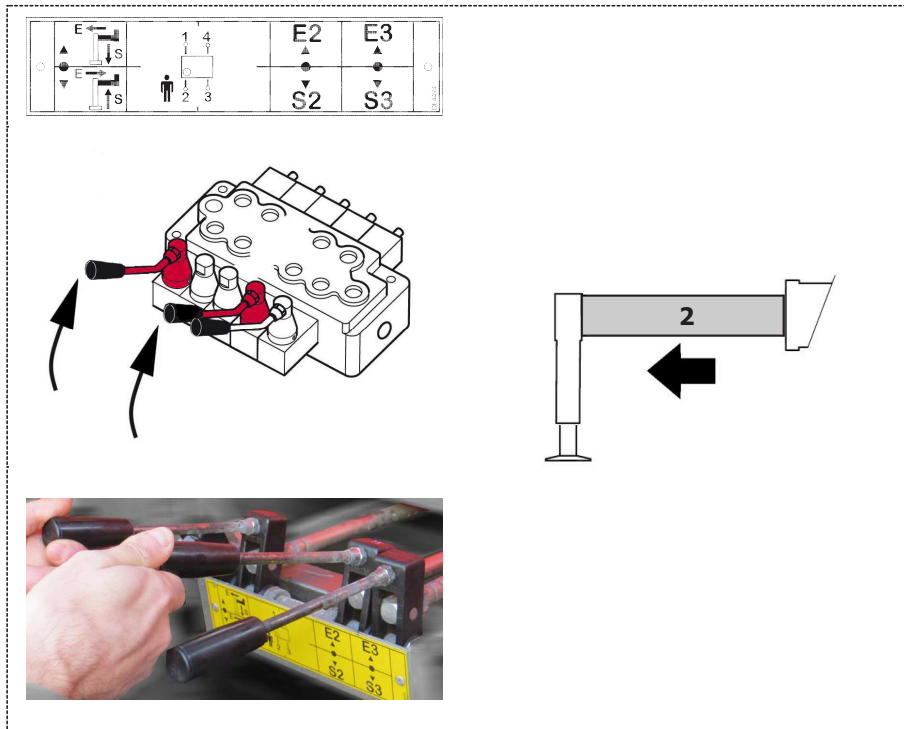

- Exit of outrigger ram - position 2 (**S2**)

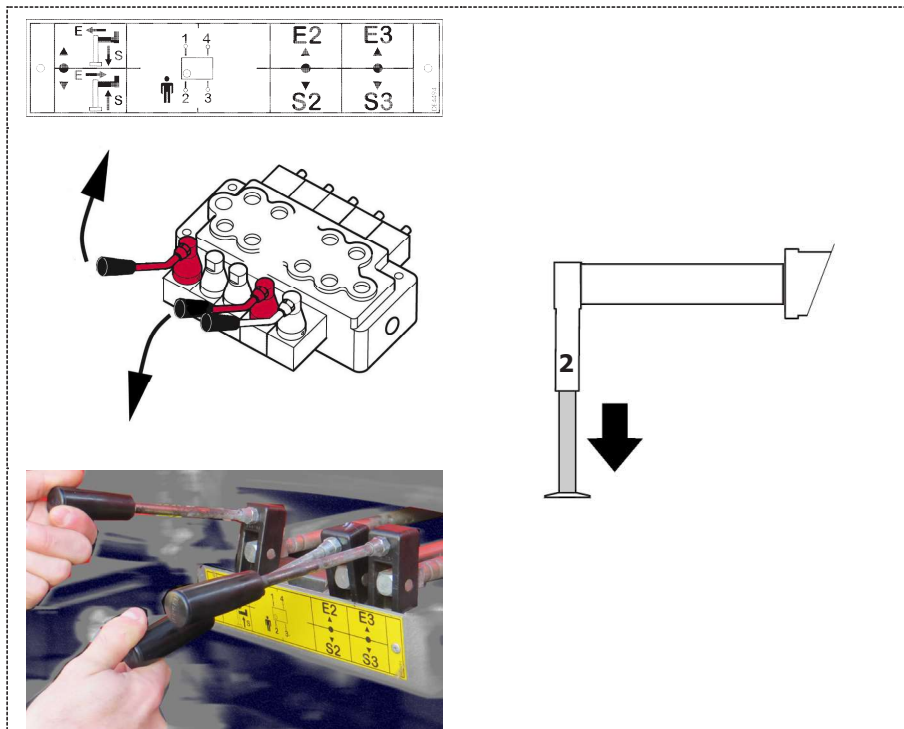

## **i** Manually extendable outrigger supports

If the crane is fitted with manually extendable outrigger supports, follow this procedure.

- Unlock the locking device placed on the beam (version A and version B).

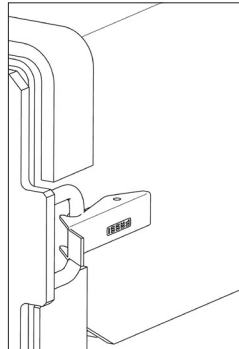

Version A

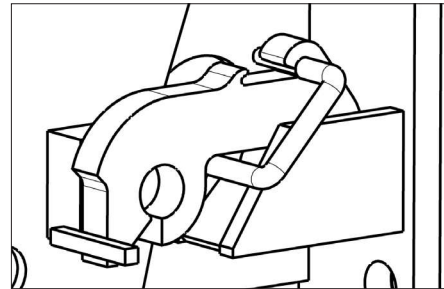

Version B

- Rotate the safety lever placed on the beam to the open padlock position (180°). In this way the safety pin is disengaged.

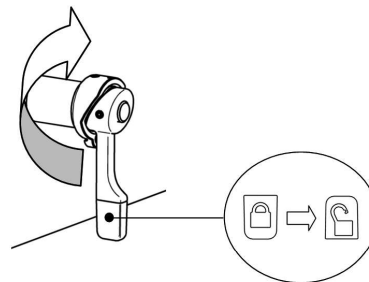

- Completely extend the outrigger support by operating the specific handle.
- Once the extension is completed, rotate the safety lever from open padlock position to closed padlock position (180°).

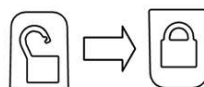

While operating outrigger supports, grab only the dedicated handles.



Above operations must be carried out for every locking device that is fitted on manually extendable supports.



Make sure outrigger supports are completely extended and locked (the safety pin levers must be in closed padlock position).  
Check that the yellow triangle vertices are near the edge of the beam (fig. 6.7) and the edge of supports (if they are multi-extendable - fig. 6.8).

## **i** Manually tiltable outrigger rams

If the crane is fitted with manually tiltable outrigger rams, follow this procedure to place them into working position.

- Manually support the outrigger ram (if OET is fitted this operation is not necessary), remove the check pin (fig. 6.9 - position 1) and then the locking pin (fig. 6.9 - position 2) from the seat.

 Once the locking pin (fig. 6.9 - position 2) is removed, the outrigger ram may fall down (if OET is not fitted), therefore a residual crushing risk occurs for operator and persons in the vicinity. In order to prevent it, during this operation it is necessary to manually support the ram and be out of its working area.

- Carefully place the outrigger ram into working position (vertically towards the ground), insert the locking pin in its seat and secure it with the check pin.



Fig. 6.9

 The locking pin is made of special material. Do not replace it with others: your safety depends on it.

 It is forbidden to use plumbing pipes to tilt the outrigger rams.

 Check the locking pin is correctly inserted and secured.



The OET (Outrigger Easy Tilt) system enables an easy tilt of manually tiltable outrigger rams thanks to a specific gas spring. To operate the rams properly, follow the above procedure, which is also represented on the plates DE13319 - DE13320 here below.

To tilt the outrigger rams, use the dedicated handle.

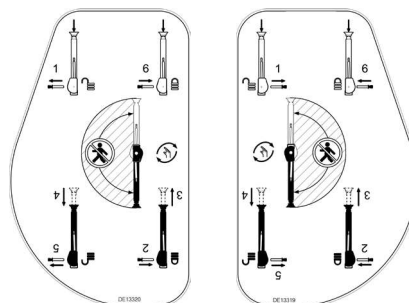

## **i** Hydraulically tiltable outrigger rams

If the crane is fitted with hydraulically tiltable outrigger rams, follow this procedure to place them into working position.

- Close the tap of fig. 6.10 to prevent the outrigger ram exit.

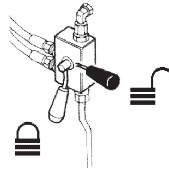
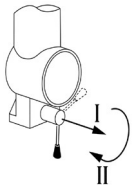
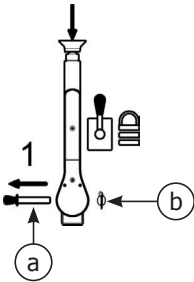

Fig. 6.10

- Operate the control lever to tilt the ram into transport position, in order to pressurize the system (with lateral pin: to check the pressurisation is fulfilled, ensure that the pin in the ram fork can be seen from the hole).
- Unlock the pivoting of the tiltable ram following this procedure (according to the locking system):

With front pin	With lateral pin
<p>◇ turn the lever clockwise while slightly pulling it outwards.</p> 	<p>◇ remove the check pin (position b) and then the locking pin (position a).</p> 



In both versions (with front and lateral pin), it is forbidden to unlock the pivoting of the tiltable ram without operating first the control lever for its rest positioning.

- Select the outrigger ram and operate the control lever to tilt the ram into its working position (vertical towards the ground).

- Lock again the pivoting of the tiltable ram following this procedure (according to the locking system):

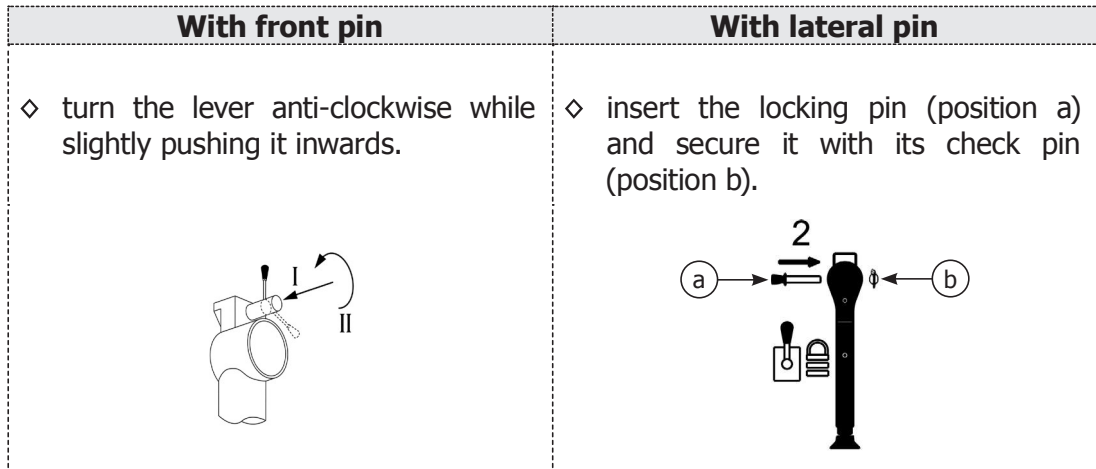

Check the pivoting of the tiltable ram is properly locked.

- Open the tap of fig. 6.10 to enable the outrigger ram exit.

The previous procedure is described on the plates DE8030-DE8031 or DE13453-DE13463 here below (according to the locking system).

